

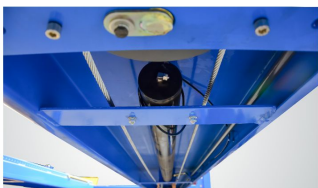

▲ Electric control device with UP, LOCK and DOWN buttons.



▲ Oil-water separator and solenoid air valve are installed on the power side column.



▲ High quality hydraulic cylinder utilizes imported oil seals.

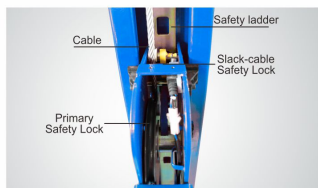

▲ Double safety locks provide additional safety.

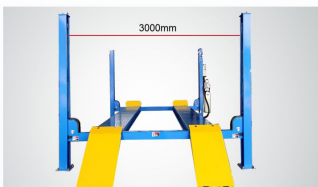

▲ Extremely wide of 3000mm between 2 columns to accommodate wide vehicles.

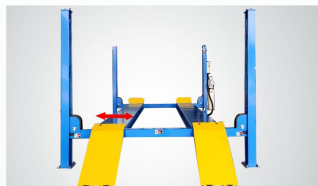

▲ Stepless adjustable width between platforms.



▲ Optional Turnplate. Each alignment lift need two units. Kits No.40101 Only available on 410A



▲ Optional Rolling Jacks
J6H: manual hydraulic type 2,800KG.
J6A: pneumatic hydraulic type 2,800KG.

ELECTRIC CONTROL FOUR POST LIFT

MODEL 410 410A

PEAK
World-class lifts

More comfort by more width, the 410 Series boasts an impressive 4,500 kg lifting capacity, designed to handle virtually all daily requirements for general service and precision alignment work. Featuring an exceptional 3,000 mm column spacing, this series provides effortless vehicle access and ample working space for a wide range of vehicles. The stepless adjustment system ensures precise fit for varying wheelbases, delivering unmatched versatility in your service bay.





GENERAL SERVICE FOUR POST LIFT



ALIGNMENT FOUR POST LIFT

MODEL 410

FEATURES

- 24V electrical control operation system.
- 3000mm oversized width between columns, accommodates more vehicles
- High quality hydraulic cylinder design and manufactured at high standard.
- Mechanical self-locking and air-release safety lock system.
- Dual safety devices mechanism: both primary safety locks and cable-slack protection system.
- Non-skid diamond platforms.
- Stepless adjustable width between platforms.

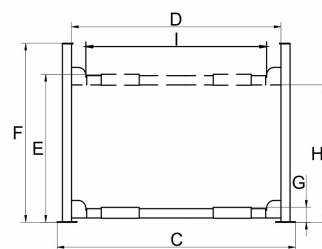
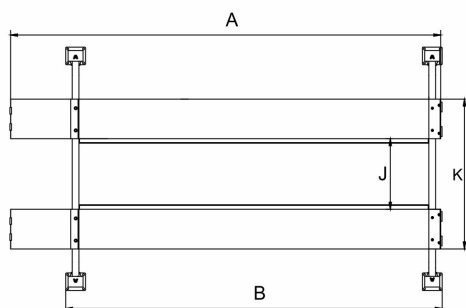

410

MODEL 410A

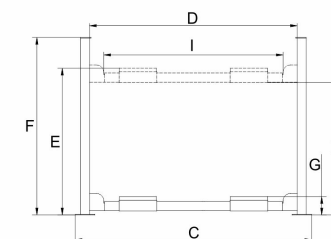
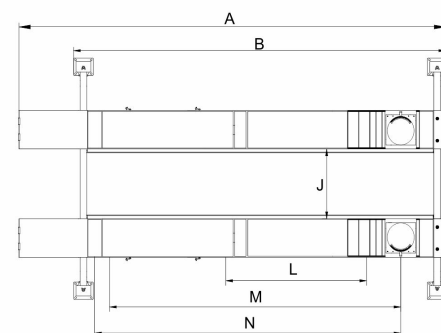

410A

SPECIFICATIONS

Model	Lifting Capacity	Lifting Time	A	B	C	D	E	F	G	H	I	J	K	L	M	N	Gross Weight	Motor Power		
			Overall Length (Inc Ramps)	Outside edge of crossbeams	Overall Width	Width Between Posts	Max. Lifting Height	Max. Lock Height to top of runway	Overall Height	Minimum Height	Max. Undersneath Height	Max. Lock Undersneath Height	Drive-Thru Clearance	Width Between Runways	Outside Edge of Runways	Min. Four Wheel Align			Max. Four Wheel Align	Max. Two Wheel Align
410	4.5 T (10,000lbs)	45S	5910mm (232 5/8")	4988mm (196 3/4")	3358mm (132 1/8")	3000mm (118 1/8")	1870mm (73 5/8")	1820mm (71 7/8")	2185mm (86")	170mm (6 5/8")	1730mm (68 1/8")	1692mm (66 5/8")	2648mm (104 1/8")	1100mm(43 1/4") Min.85mm(3 3/8")~ Max.1385mm(53 3/4")	2116mm (83 1/4") Min.1101mm(43 3/8")~ Max.2381mm (93 3/4")			1025KG (2,260lbs)	3.0HP	
410A	4.5 T (10,000lbs)	45S	5910mm (232 5/8")	4988mm (196 3/4")	3358mm (132 1/8")	3000mm (118 1/8")	1820mm (70 7/8")	1820mm (70 7/8")	2185mm (86")	170mm (6 5/8")	1730mm (68 1/8")	1692mm (66 5/8")	2648mm (104 1/8")	1100mm(43 1/4") Min.85mm(3 3/8")~ Max.1385mm(53 3/4")	2116mm (83 1/4") Min.1101mm(43 3/8")~ Max.2381mm (93 3/4")	2080mm (81 7/8")	3650mm (151 1/2")	4000mm (157 1/2")	1262KG (2,826lbs)	3.0HP

The images, technical specifications, and descriptions shown here are subject to change without prior notice. Please contact us for the latest information if necessary